

CONVERSION:
POWER TO LOCK <=> POWER TO OPEN

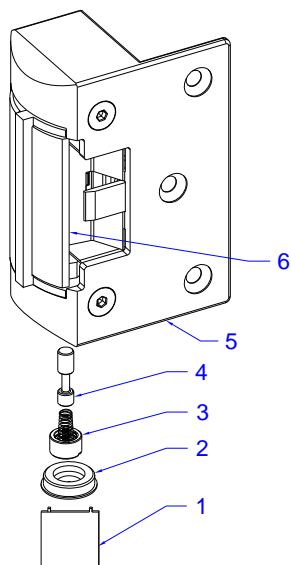

Figure 4A

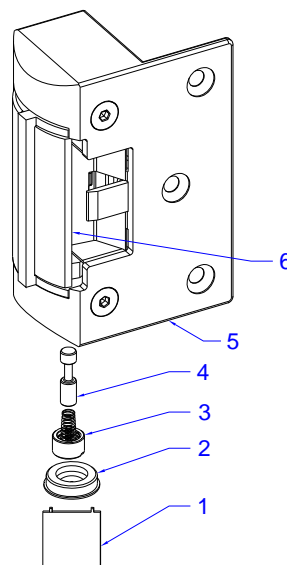

Figure 4B

WARNING: Do not attempt to swivel the keeper while changing function. The spring screw must be in place before operating the strike.

Procedures to convert Power to Open (Figure 4B) to Power to Lock (Figure 4A):

- Step 1: Remove the security plug cover(2) with the provided security screw(1).
- Step 2: Remove the spring screw(3) from the opening hole.
- Step 3: Remove the Barbell (4) and replace in reverse position with long part in and short part out.
- Step 4: Replace the spring screw(3) .
- Step 5: Refit the security plug cover(2) .

Procedures to convert Power to Lock (Figure 4A) to Power to Open (Figure 4B):

- Step 1: Remove the security plug cover(2) with the provided security screw(1).
- Step 2: Remove the spring screw(3) from the opening hole.
- Step 3: Remove the Barbell (4) and replace in reverse position with short part in and long part out.
- Step 4: Replace the spring screw(3) .
- Step 5: Refit the security plug cover(2) .